

Houses Type D2 - Plans, Section, Elevations

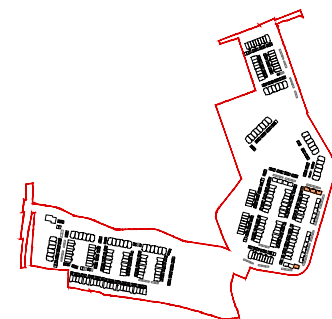

Figured dimensions only to be used. This drawing is copyright of O'Mahony Pike Architects Ltd. All information is shared as per approved use in accordance with BS1192(2007) + A2(2016), Table 5; Standard Codes for Suitability of Models and Documents. If 'Information Approval Check' is empty, this information has been shared at SO - WIP.

o'mahony pike

architecture | urban design
 email: info@omahonypike.com
 tel: +353 1 202 7400
 fax: +353 1 283 0822
 www.omahonypike.com

Project: Ballyoulster SHD (Phase 1)
Location: Ballyoulster, Celbridge, Co. Kildare
Client: Kieran Curtin, Receiver over certain assets of Maplewood Developments Unlimited Company (in liquidation and in receivership)

Drawing Title: Houses Type D2- Plans, Section, Elevations
Drawing No.: 20007-OMP-HT-D2-DR-A-1000

Project No.: 20007
Project Lead: DMD
Drawn By: KÖC
Model No.: 20007-OMP-HT-ZZ-DR-A-1000
Purpose: Planning

Scale @ A3: As Noted
Date Printed: 10-06-2022
Current Rev.: P.02

Suitability - Checked By - Date